

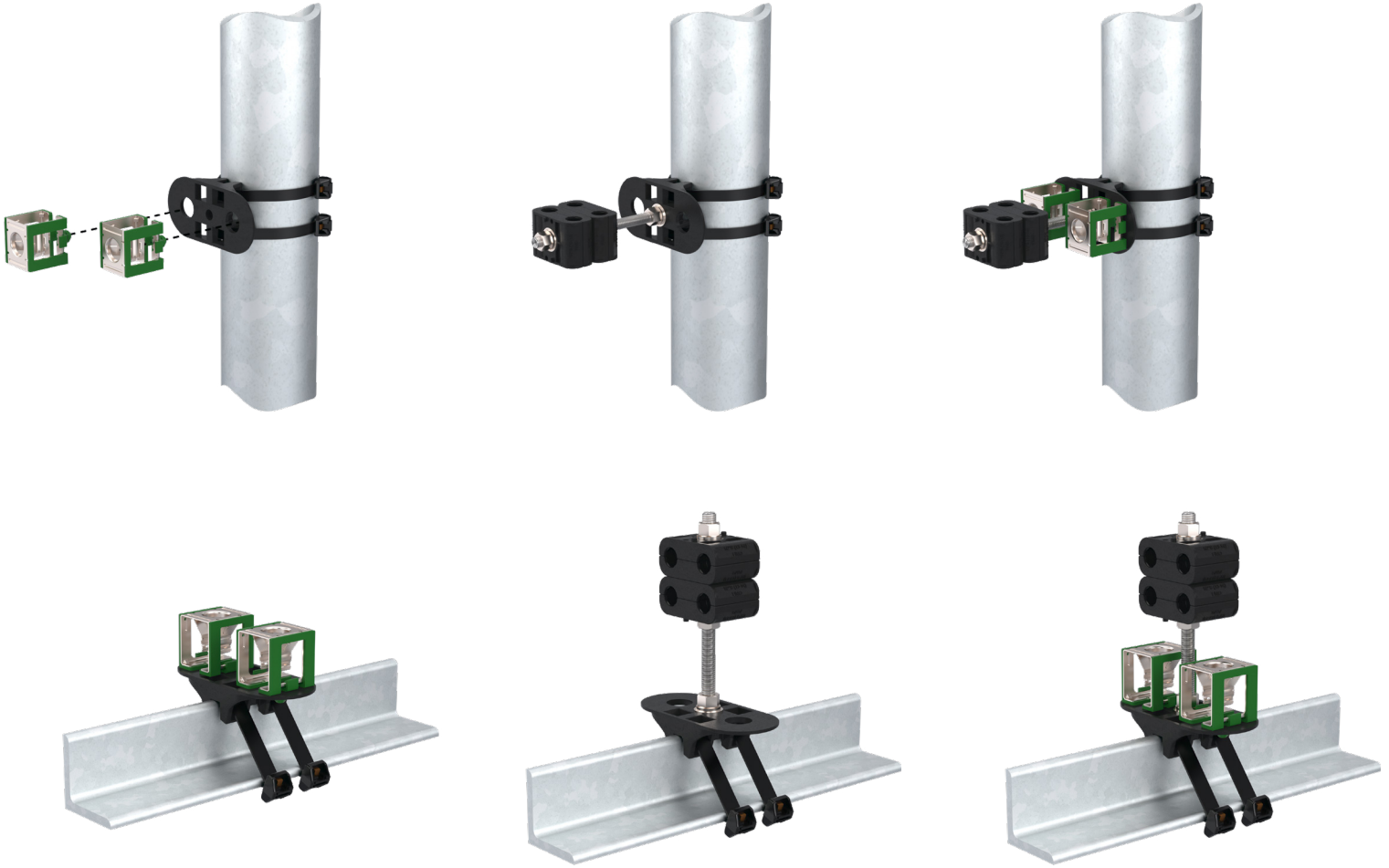

## SPECIFICATIONS

<b>General</b>	The PIM Shield Multi-Function Snap-in Adapter provides a low passive intermodulation method to support two stacks of snap-in style cable hangers and/or one 3/8" threaded rod in high-risk PIM zones. (3/8" back nut not included).
<b>Mounting</b>	Secure the Snap-in Adapter to existing round or angle member using two PIM Shield Cable Straps (900443-16-50 or 900443-27-25) or equivalent. Torque 3/8" threaded hardware to 10 FT-LB (ConcealFab tool 900053).
<b>Round Member Attachment</b>	2.37-inch minimum outside diameter
<b>Angle Member Attachment</b>	0.38-inch maximum angle flange thickness
<b>System PIM Performance</b>	IM3 <-100 dBm when tested in accordance with proposed IEC 62037-8, near field test, 2x 20W test tones, while subjected to dynamic stimulus. To achieve specified PIM performance, torque 3/8" hardware to 10 FT-LB.
<b>Material</b>	UV Stable, glass filled Nylon
<b>Operating Temperature</b>	-40°C to +70°C
<b>Case Dimensions</b>	15-inch x 11-inch x 8-inch
<b>Case Weight</b>	8.4 Lbs.
<b>Qty. Per Case</b>	10

**2X SNAP-IN LAUNCH 1X THREADED ROD LAUNCH**



**Patent Pending design allows secure attachment to round or angle members at cell sites.**

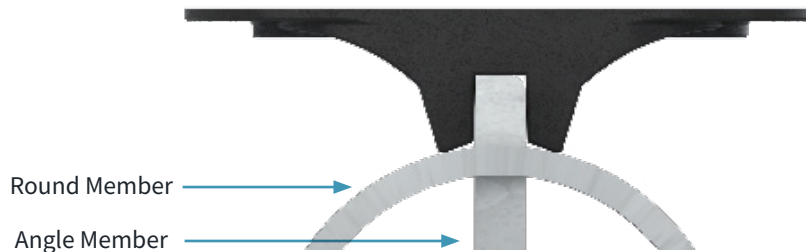

**Note:** 901045-10 Multi-Function Base is designed to support one threaded rod and/or two stacks of Snap-in Cable Hangers to round or angle members at cell sites.

**STEP 1:** Attach Threaded Rod (sold separately) to Snap-in Support Base (Torque greater than 10 ft-lb). Use existing site hardware or new Threaded Rod Kit (PN's: 900210-10, 900211-10, 900212-10, 900381-10). (OMIT THIS STEP IF NOT SECURING A THREADED ROD.)

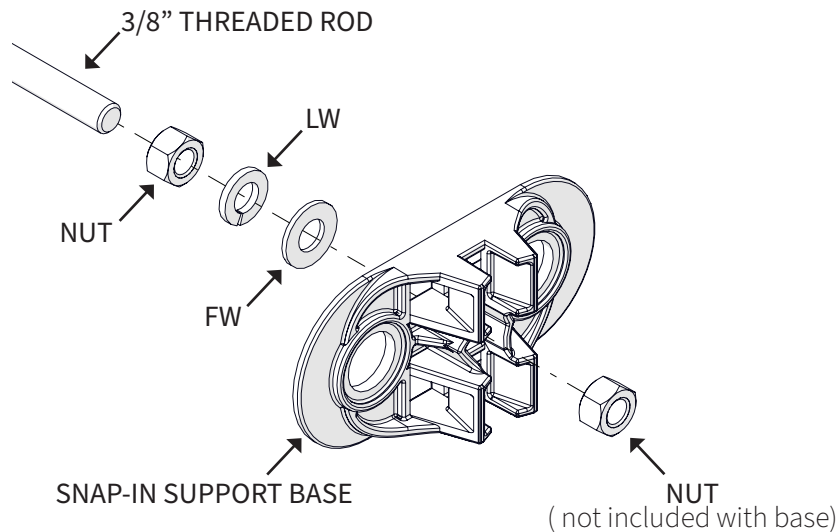

STEP 1

**STEP 2:** Secure Snap-in Support Base to a round or angle member using Cable Strap(s) (PN's: 900443-16-50 or 900443-27-25). Use Strap Tensioning tool (900442 or equivalent) to tighten Cable Strap(s). Trim Strap(s) flush to Locking Head.

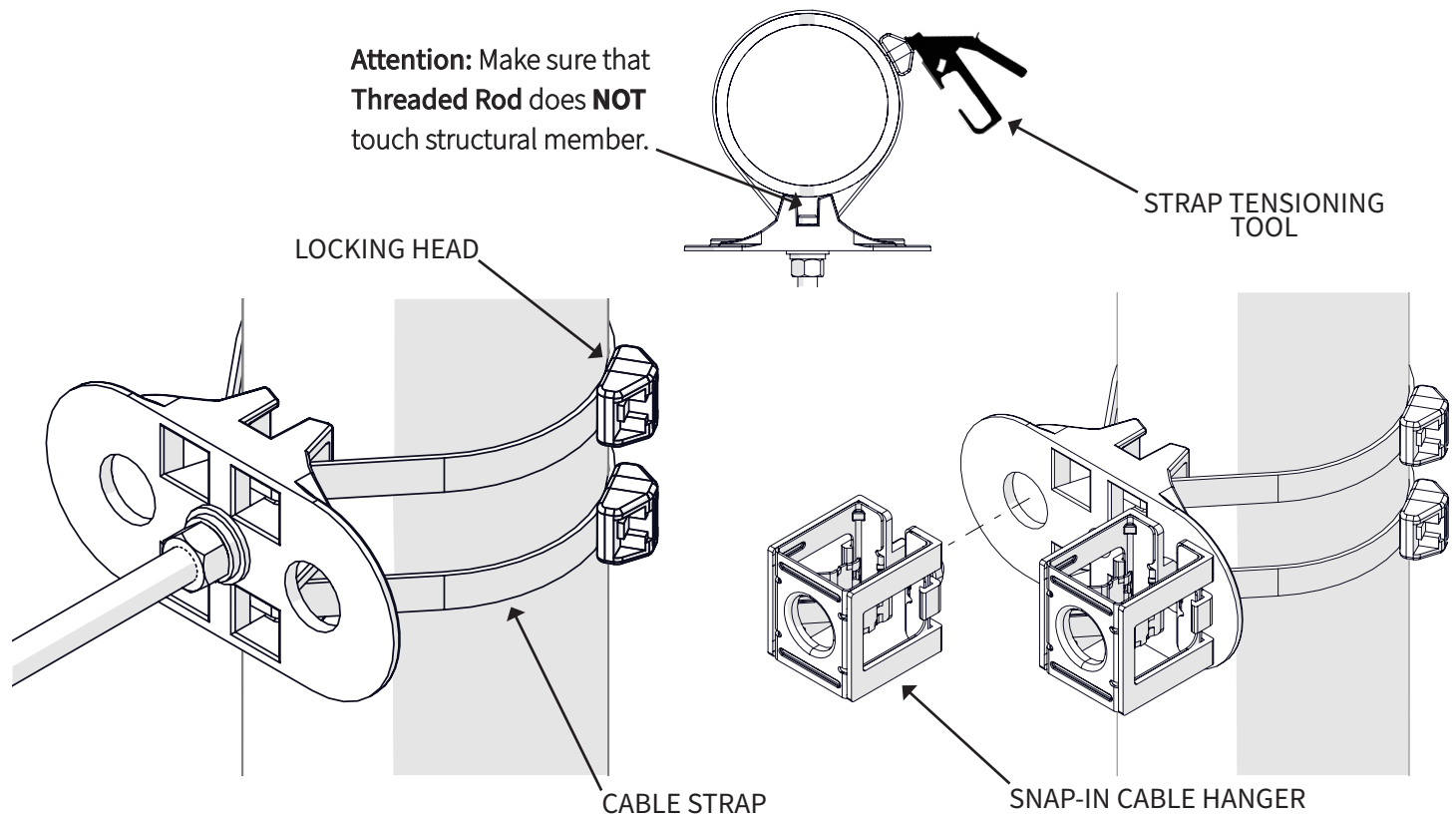

STEP 2

STEP 3

**STEP 3:** Install low PIM stackable Snap-in Cable Hangers (sold separately, PN's: PSHS-xxxx-10 or PSPS-xxx-10) as required into mounting holes provided. Maximum stack height = 3.