

USE SLOT FOR DOWN TILT APPLICATION,
USE HOLE WHEN PIPE MOUNT IS VERTICAL.

2-3/8" TO 3-1/2"
O.D. PIPE
(ORDER SEPARATELY)

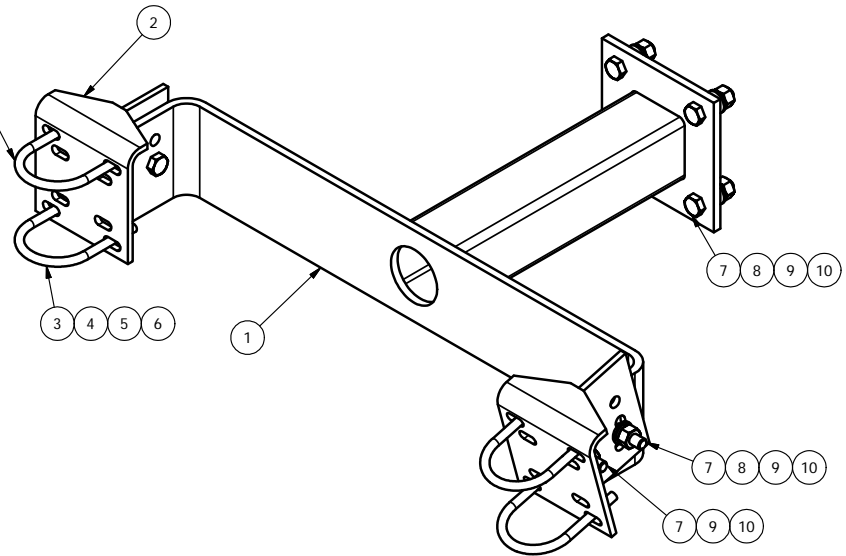

PARTS LIST

| ITEM | QTY | PART NO. | PART DESCRIPTION | LENGTH | UNIT WT. | NET WT. |
|------|-----|----------|---|---------|----------|---------|
| 1 | 1 | X-97961 | DSM2 MAIN STANDOFF BRACKET | | 60.00 | 60.00 |
| 2 | 2 | X-ATB | PIPE ATTACHMENT BRACKET | | 10.68 | 21.37 |
| 3 | 4 | X-UB1358 | 1/2" X 3-5/8" X 5-1/2" X 3" U-BOLT (HDG.) | | 0.77 | 3.09 |
| 3 | 4 | X-UB1300 | 1/2" X 3" X 5" X 2" UBOLT (HDG.) | | 0.70 | 2.80 |
| 3 | 4 | X-UB1212 | 1/2" X 2-1/2" X 4-1/2" X 2" UBOLT (HDG.) | | 0.63 | 2.52 |
| 4 | 8 | G12FW | 1/2" HDG USS FLATWASHER | | 0.03 | 0.27 |
| 5 | 8 | G12LW | 1/2" HDG LOCKWASHER | | 0.01 | 0.11 |
| 6 | 8 | G12NUT | 1/2" HDG HEAVY 2H HEX NUT | | 0.07 | 0.57 |
| 7 | 8 | A582112 | 5/8" X 2-1/2" HDG A325 HEX BOLT | 2.5 in. | 0.33 | 2.67 |
| 8 | 6 | A58FW | 5/8" HDG A325 FLATWASHER | | 0.03 | 0.20 |
| 9 | 8 | G58LW | 5/8" HDG LOCKWASHER | | 0.03 | 0.21 |
| 10 | 8 | A58NUT | 5/8" HDG A325 HEX NUT | | 0.13 | 1.04 |

TOTAL WT. # 94.27

TOLERANCE NOTE

TOLERANCES ON DIMENSIONS, UNLESS OTHERWISE NOTED ARE:
SAWED, SHEARED AND GAS CUT EDGES ($\pm 0.030"$)
DRILLED AND GAS CUT HOLES ($\pm 0.030"$) - NO CONING OF HOLES
LASER CUT EDGES AND HOLES ($\pm 0.010"$) - NO CONING OF HOLES
BENDS ARE $\pm 1/2$ DEGREE - ALL OTHER MACHINING ($\pm 0.030"$)
ALL OTHER ASSEMBLY ($\pm 0.060"$)

PROPRIETARY NOTE

THE DATA AND TECHNIQUES CONTAINED IN THIS DRAWING ARE PROPRIETARY INFORMATION OF VALMONT INDUSTRIES AND CONSIDERED A TRADE SECRET. ANY USE OR DISCLOSURE WITHOUT THE CONSENT OF VALMONT INDUSTRIES IS STRICTLY PROHIBITED.

DESCRIPTION
**DUAL STANDOFF ARM
FOR TWO
ANTENNA PIPES**

SITE PRO 1
A valmont COMPANY

Engineering Support Team:
1-888-753-7446

Locations:
New York, NY
Atlanta, GA
Los Angeles, CA
Plymouth, IN
Salem, OR
Dallas, TX

DRAWN BY
CEK 11/12/2010

CPD NO.
4779

DRAWING USAGE
CUSTOMER

ENG. APPROVAL

CHECKED BY
BMC 1/6/2012

PART NO.
DSM2

DWG. NO.
DSM2

| REV | DESCRIPTION OF REVISIONS | CPD | BY | DATE |
|------------------|------------------------------|------|-----|----------|
| A | REPLACED X-210746 WITH X-ATB | 4779 | CEK | 1/5/2012 |
| REVISION HISTORY | | | | |