

NOTE:
PLATFORM, FOOTPADS, HANDRAILS, AND HANDRAIL SPLICES
ARE NOT INCLUDED.

MOUNTS ONLY TO MOPEN-4. HANDRAIL REQUIRED.

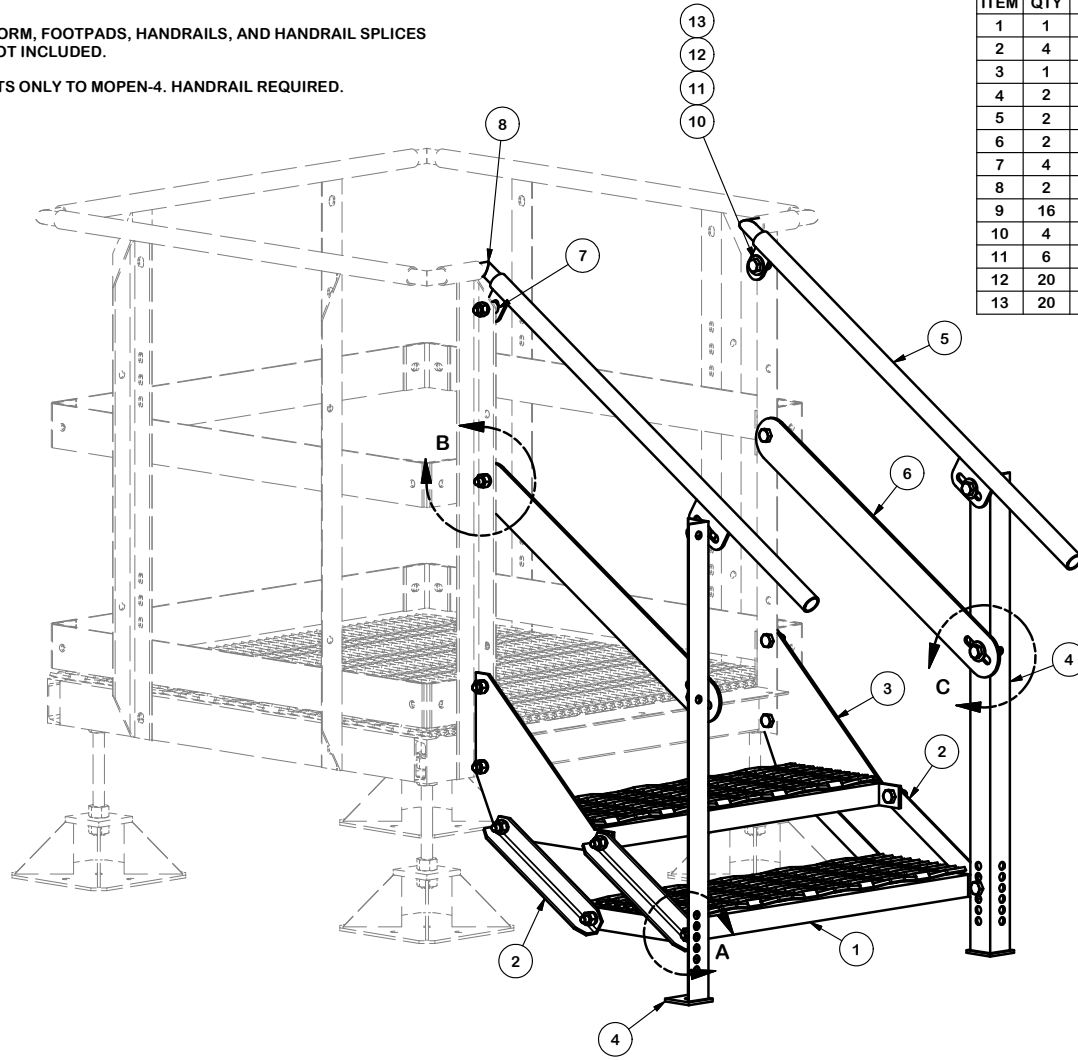

PARTS LIST						
ITEM	QTY	PART NO.	PART DESCRIPTION	LENGTH	UNIT WT.	NET WT.
1	1	X-MSTEP	STAIR WELDMENT FOR MODULAR EQUIPMENT PLATFORM		37.92	37.92
2	4	X-MS2A	SIDE ANGLE FOR TWO STAIR ASSEMBLY	15 1/4 in	3.20	12.80
3	1	X-MSWS	WELDED STEP FOR 1 LEVEL MODULAR STEP		52.77	52.77
4	2	X-MSHUP	HANDRAIL WELDMENT		12.25	24.49
5	2	X-MSH2	MODULAR HANRAIL FOR TWO STAIRS		10.53	21.06
6	2	X-MSTEP2MR	MID RAIL FOR MSTEP2	35 1/4 in	10.14	20.29
7	4	X-MSHSP	HANDRAIL SPACER PIPE	1 in	0.10	0.40
8	2	X-MTRC	MODULAR TOP RAIL CORNER SPLICE		1.25	2.51
9	16	G58134	5/8" x 1-3/4" HDG BOLT	1 3/4 in	0.27	4.30
10	4	A58234	5/8" x 2-3/4" HDG A325 HEX BOLT	2 3/4 in	0.36	1.42
11	6	G58FW	5/8" HDG USS FLATWASHER	1/8 in	0.07	0.42
12	20	G58LW	5/8" HDG LOCKWASHER		0.03	0.52
13	20	G58NUT	5/8" HDG HEAVY 2H HEX NUT		0.13	2.60
TOTAL WT. #						181.51

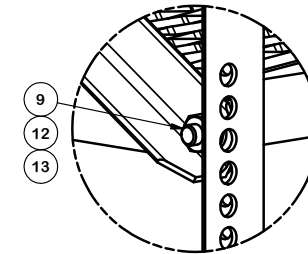

DETAIL A

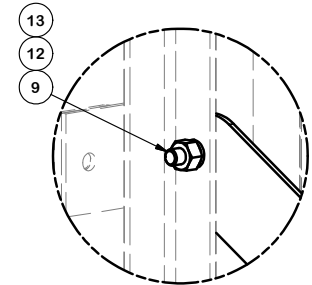

DETAIL B

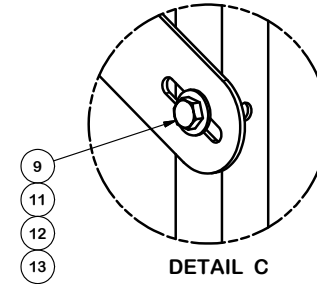

DETAIL C

TOLERANCE NOTES

TOLERANCES ON DIMENSIONS, UNLESS OTHERWISE NOTED ARE:
SAWED, SHEARED AND GAS CUT EDGES ($\pm 0.030"$)
DRILLED AND GAS CUT HOLES ($\pm 0.030"$) - NO CONING OF HOLES
LASER CUT EDGES AND HOLES ($\pm 0.010"$) - NO CONING OF HOLES
BENDS ARE $\pm 1/2$ DEGREE
ALL OTHER MACHINING ($\pm 0.030"$)
ALL OTHER ASSEMBLY ($\pm 0.060"$)

PROPRIETARY NOTE:
THE DATA AND TECHNIQUES CONTAINED IN THIS DRAWING ARE PROPRIETARY INFORMATION OF VALMONT INDUSTRIES AND CONSIDERED A TRADE SECRET. ANY USE OR DISCLOSURE WITHOUT THE CONSENT OF VALMONT INDUSTRIES IS STRICTLY PROHIBITED.

DESCRIPTION
TWO STAIR ASSEMBLY FOR
MODULAR EQUIPMENT PLATFORM

SITE PRO 1
Engineering Support Team:
1-888-753-7446
Locations:
New York, NY
Atlanta, GA
Los Angeles, CA
Plymouth, IN
Salem, OR
Dallas, TX

REV	DESCRIPTION OF REVISIONS	CPD	BY	DATE
A	ADDED MID RAIL FOR HANDRAIL	CEK		7/13/2016

CPD NO.	DRAWN BY	ENG. APPROVAL
	CEK 2/2/2016	7/15/2016
CLASS	SUB	DRAWING USAGE
81	02	CUSTOMER

PART NO.	DWG. NO.
MSTEP-2	MSTEP-2

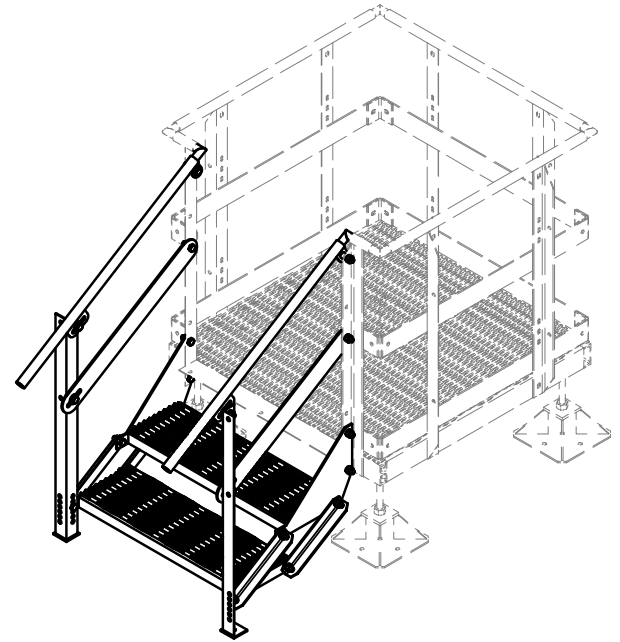
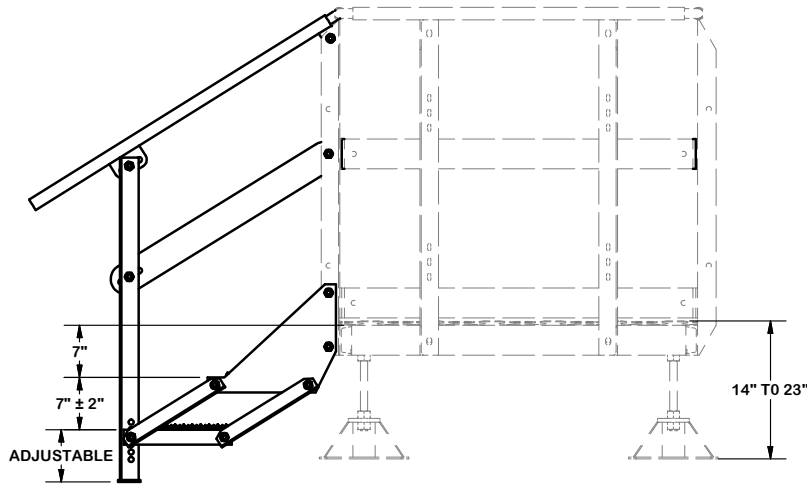
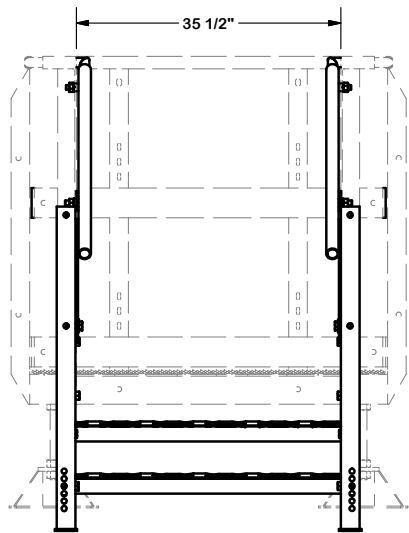

REV	DESCRIPTION OF REVISIONS	CPD	BY	DATE
A	ADDED MID RAIL FOR HANDRAIL		CEK	7/13/2016
REVISION HISTORY				

TOLERANCE NOTES

TOLERANCES ON DIMENSIONS, UNLESS OTHERWISE NOTED ARE:
 SAWED, SHEARED AND GAS CUT EDGES ($\pm 0.030"$)
 DRILLED AND GAS CUT HOLES ($\pm 0.030"$) - NO CONING OF HOLES
 LASER CUT EDGES AND HOLES ($\pm 0.010"$) - NO CONING OF HOLES
 BENDS ARE $\pm 1/2$ DEGREE
 ALL OTHER MACHINING ($\pm 0.030"$)
 ALL OTHER ASSEMBLY ($\pm 0.060"$)

PROPRIETARY NOTE:
 THE DATA AND TECHNIQUES CONTAINED IN THIS DRAWING ARE PROPRIETARY INFORMATION OF VALMONT INDUSTRIES AND CONSIDERED A TRADE SECRET. ANY USE OR DISCLOSURE WITHOUT THE CONSENT OF VALMONT INDUSTRIES IS STRICTLY PROHIBITED.

DESCRIPTION		DRAWING USAGE	
TWO STAIR ASSEMBLY FOR MODULAR EQUIPMENT PLATFORM		CUSTOMER	
CPD NO.	DRAWN BY	ENG. APPROVAL	CHECKED BY
	CEK 2/2/2016	7/15/2016	BMC 7/15/2016
CLASS	SUB		
81	02		

 A valmont COMPANY	Engineering Support Team: 1-888-753-7446	Locations: New York, NY Atlanta, GA Los Angeles, CA Plymouth, IN Salem, OR Dallas, TX
	PART NO. MSTEP-2	DWG. NO. MSTEP-2