

PARTS LIST						
ITEM	QTY	PART NO.	PART DESCRIPTION	LENGTH	UNIT WT.	NET WT.
1	2	X-160941	6' STANDOFF ARM		154.25	308.50
2	1	X-HDCAMTBW	CLAMP WELDMENT FOR BCAM-HD		33.86	33.86
3	1	X-MHTPHD	MULTI-HOLE TAPER PLATE WELDMENT		36.24	36.24
4	2	X-LCBP4	BENT BACKING PLATE	13.000 in	20.04	40.09
5	1	X-HDCAMSS	ANGLE ADJUSTMENT WELDMENT FOR BCAM-HD		16.39	16.39
6	1	X-HDCAMSP	POSITIONING PLATE WELDMENT FOR BCAM-HD		2.58	2.58
7	2	X-SPTB278	SLIDING PIPE TIE BACK PLATE	5.500 in	5.70	11.40
8	4	X-TBCA	TIE BACK CLIP ANGLE		2.01	8.02
9	10	SCX2	CROSSOVER PLATE	7.000 in	4.80	47.96
10	4	SCX4	CROSSOVER PLATE	8.500 in	6.02	24.09
11	4	MCP	CLAMP HALF 1/2" THICK, 11-5/8" LONG	12.071 in	3.59	14.37
12	4	DCP	1/2" THICK, 5-3/4" CNTER TO CENTER CLAMP HALF	8 1/8	2.36	9.45
13	4	X-183736	TIE BACK PLATE	7.250 in	3.98	15.92
14	2	X-184158	STRUT ARM	144.000 in	96.67	193.34
15	2	P30174	2-7/8" O.D. x 174" SCH. 40 PIPE	174.000 in	84.20	168.39
16	6	A3405	3/4" UNC HEX BOLT (A325)	5	0.82	4.91
17	2	A3403	3/4" X 3" UNC HEX BOLT (A325)	3	0.57	1.13
18	8	G34LW	3/4" HDG LOCKWASHER		0.04	0.34
19	8	G34NUT	3/4" HDG HEAVY 2H HEX NUT		0.21	1.70
20	4	X-UB5300	5/8" X 3" X 5-1/4" X 2-1/2" U-BOLT (HDG.)		1.15	4.60
21	8	G58R-18	5/8" x 18" THREADED ROD (HDG.)		1.57	12.54
22	4	G58R-12	5/8" x 12" THREADED ROD (HDG.)		1.05	4.18
23	4	G58R-8	5/8" x 8" THREADED ROD (HDG.)		0.70	2.79
24	2	G5807	5/8" x 7" HDG HEX BOLT GR5 FULL THREAD	7	0.70	1.41
25	4	G5804	5/8" x 4" HDG HEX BOLT GR5		0.44	1.78
26	1	G5806	5/8" x 6" HDG HEX BOLT GR5 FULL THREAD	6	0.62	0.62
27	4	G5802	5/8" x 2" HDG HEX BOLT GR5		0.27	1.08
28	15	G58FW	5/8" HDG USS FLATWASHER	.122	0.07	1.06
29	38	G58LW	5/8" HDG LOCKWASHER		0.03	0.99
30	41	G58NUT	5/8" HDG HEAVY 2H HEX NUT		0.13	5.33
31	8	X-UB1418	1/2 x 4-1/8" x 6" x 3" U-BOLT	6.0000 in	0.84	6.75
32	48	X-UB1300	1/2 x 3" x 5" x 2" U-BOLT	5.0000 in	0.70	33.44
33	112	G12FW	1/2" HDG USS FLATWASHER	0.095	0.03	3.82
34	112	G12LW	1/2" HDG LOCKWASHER	.125	0.01	1.56
35	112	G12NUT	1/2" HDG HEAVY 2H HEX NUT		0.07	8.02
36	5	A	B	C	D	TABLE

TABLE					
"ASSEMBLY NO."	PART NO. "A"	PART DESCRIPTION "B"	LENGTH "C"	UNIT WT. "D"	TOTAL WT.
VOG14-WLL-3096	P3096	2-7/8" O.D. SCH. 40 PIPE	96"	46.34	1,260.90
VOG14-WLL-30120	P30120	2-7/8" O.D. SCH. 40 PIPE	120"	57.93	1,318.97

TOLERANCE NOTES

TOLERANCES ON DIMENSIONS, UNLESS OTHERWISE NOTED ARE:
SAWED, SHEARED AND GAS CUT EDGES (± 0.030")
DRILLED AND GAS CUT HOLES (± 0.030") - NO CONING OF HOLES
LASER CUT EDGES AND HOLES (± 0.010") - NO CONING OF HOLES
BENDS ARE ± 1/2 DEGREE
ALL OTHER MACHINING (± 0.030")
ALL OTHER ASSEMBLY (± 0.060")

PROPRIETARY NOTE:
THE DATA AND TECHNIQUES CONTAINED IN THIS DRAWING ARE PROPRIETARY INFORMATION OF VALMONT INDUSTRIES AND CONSIDERED A TRADE SECRET. ANY USE OR DISCLOSURE WITHOUT THE CONSENT OF VALMONT INDUSTRIES IS STRICTLY PROHIBITED.

DESCRIPTION
14' 6" HEAVY-DUTY BOG V-FRAME
W/ 2-7/8" ANTENNA PIPES
AND DOUBLE TIEBACKS

CPD NO.		DRAWN BY CMFL 11/2/2021		ENG. APPROVAL	
CLASS 87	SUB 02	DRAWING USAGE CUSTOMER		CHECKED BY BMC 11/2/2021	



Engineering
Support Team:
1-888-753-7446

Locations:
New York, NY
Atlanta, GA
Los Angeles, CA
Plymouth, IN
Salem, OR
Dallas, TX

PART NO.	VOG14-WLL-3XX
DWG. NO.	VOG14-WLL-3XX

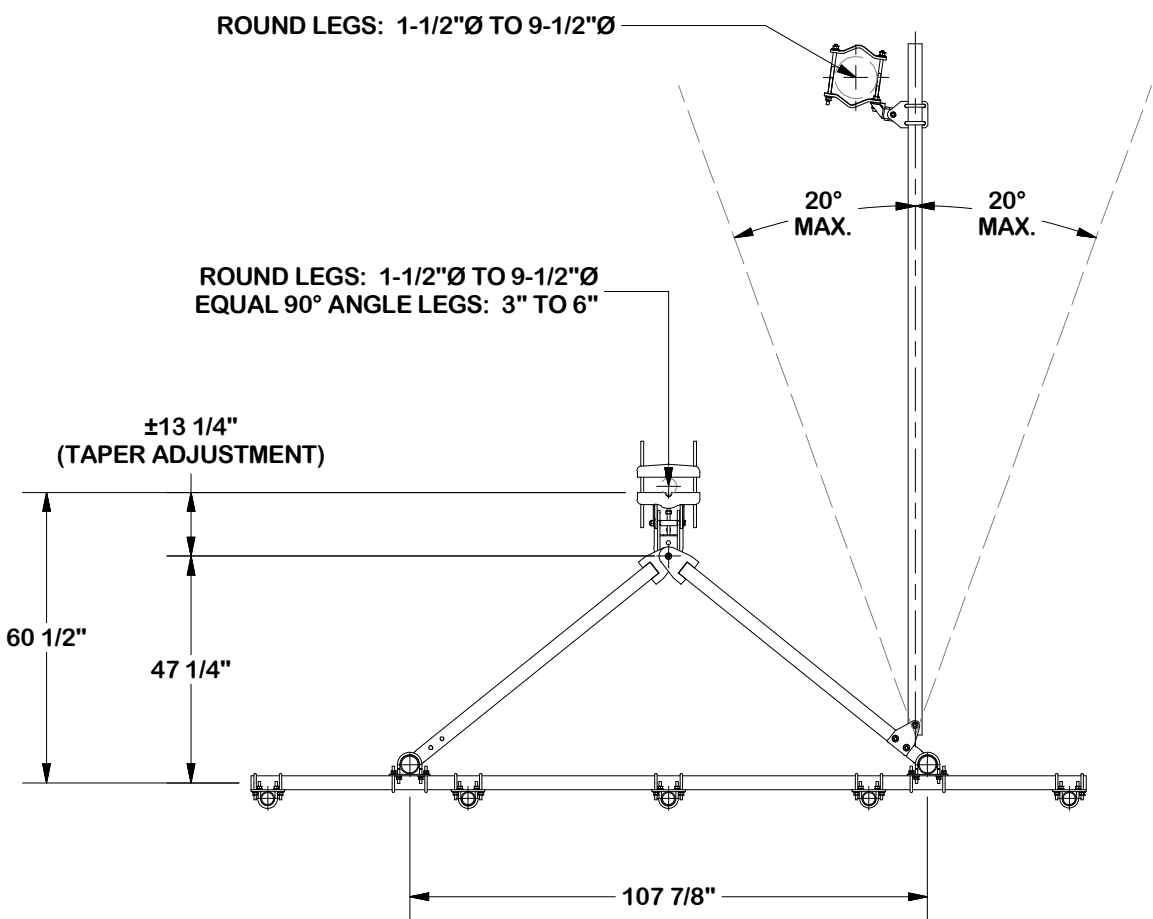

ANGLE CALIBRATING PROCEDURE:

1. MEASURE TOWER TAPER AND PICK LOWER BRACKET HOLE:
 - HOLE A = -2.6° TO 2.6°
 - HOLE B = 1.6° TO 6.8°
2. USE CALIBRATING BOLT TO ADJUST FRAME TO DESIRED TAPER
3. TORQUE LOCKING BOLTS TO 100 ft.-lbs.
4. ADVANCE LOCKING NUT TO POSITIONING PLATE, THEN TIGHTEN.

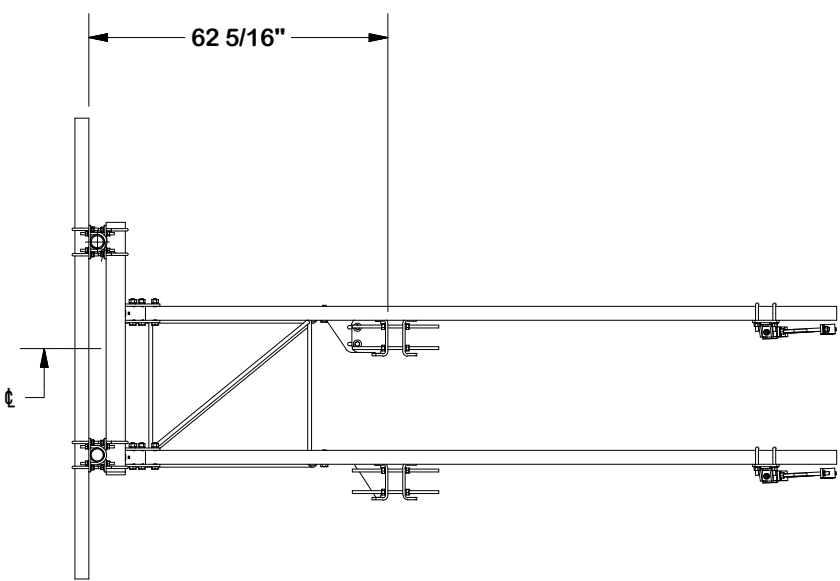
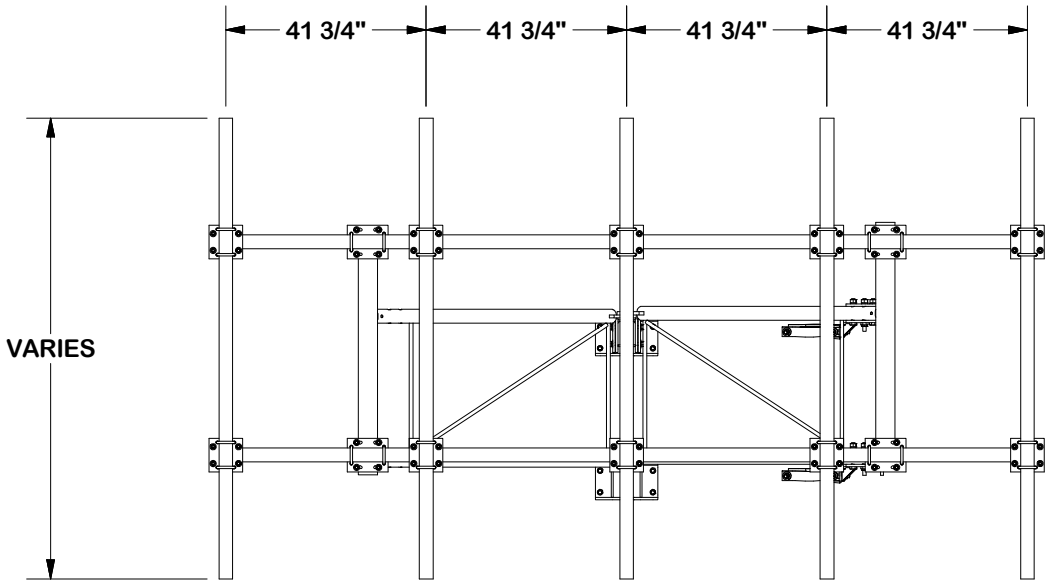
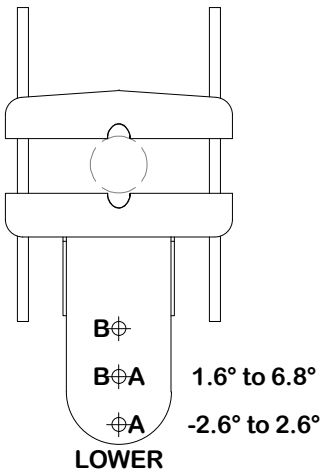
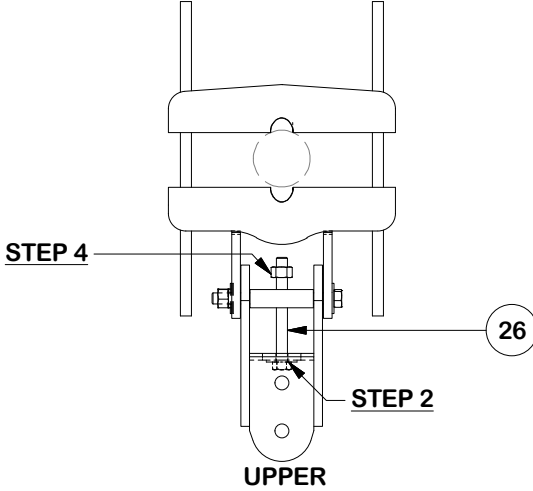

TOLERANCE NOTES

TOLERANCES ON DIMENSIONS, UNLESS OTHERWISE NOTED ARE:
 SAWED, SHEARED AND GAS CUT EDGES (± 0.030")
 DRILLED AND GAS CUT HOLES (± 0.030") - NO CONING OF HOLES
 LASER CUT EDGES AND HOLES (± 0.010") - NO CONING OF HOLES
 BENDS ARE ± 1/2 DEGREE
 ALL OTHER MACHINING (± 0.030")
 ALL OTHER ASSEMBLY (± 0.060")

PROPRIETARY NOTE:
 THE DATA AND TECHNIQUES CONTAINED IN THIS DRAWING ARE PROPRIETARY INFORMATION OF VALMONT INDUSTRIES AND CONSIDERED A TRADE SECRET. ANY USE OR DISCLOSURE WITHOUT THE CONSENT OF VALMONT INDUSTRIES IS STRICTLY PROHIBITED.

DESCRIPTION
 14' 6" HEAVY-DUTY BOG V-FRAME
 W/ 2-7/8" ANTENNA PIPES
 AND DOUBLE TIEBACKS

CPD NO.	DRAWN BY	ENG. APPROVAL
	CMFL 11/2/2021	
CLASS	DRAWING USAGE	CHECKED BY
87	CUSTOMER	BMC 11/2/2021



Locations:
 New York, NY
 Atlanta, GA
 Los Angeles, CA
 Plymouth, IN
 Salem, OR
 Dallas, TX

Engineering
 Support Team:
 1-888-753-7446

PART NO.
 VOG14-WLL-3XX

DWG. NO.
 VOG14-WLL-3XX

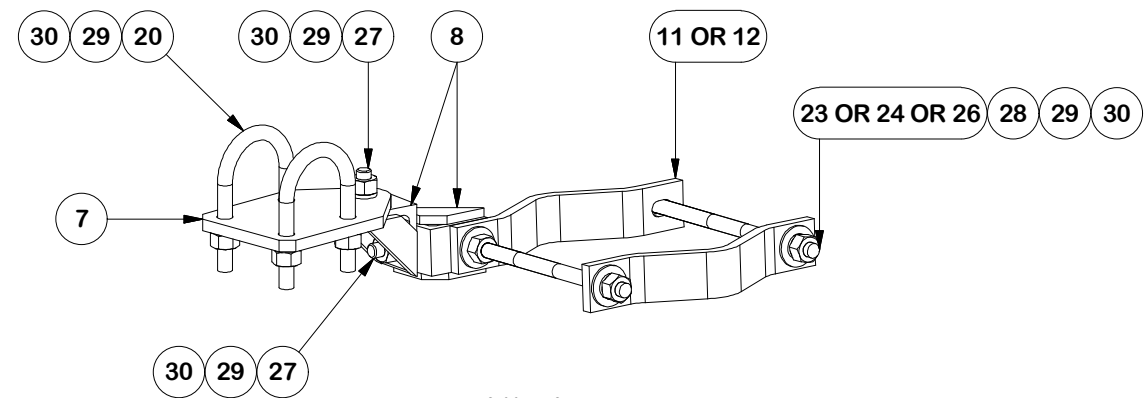
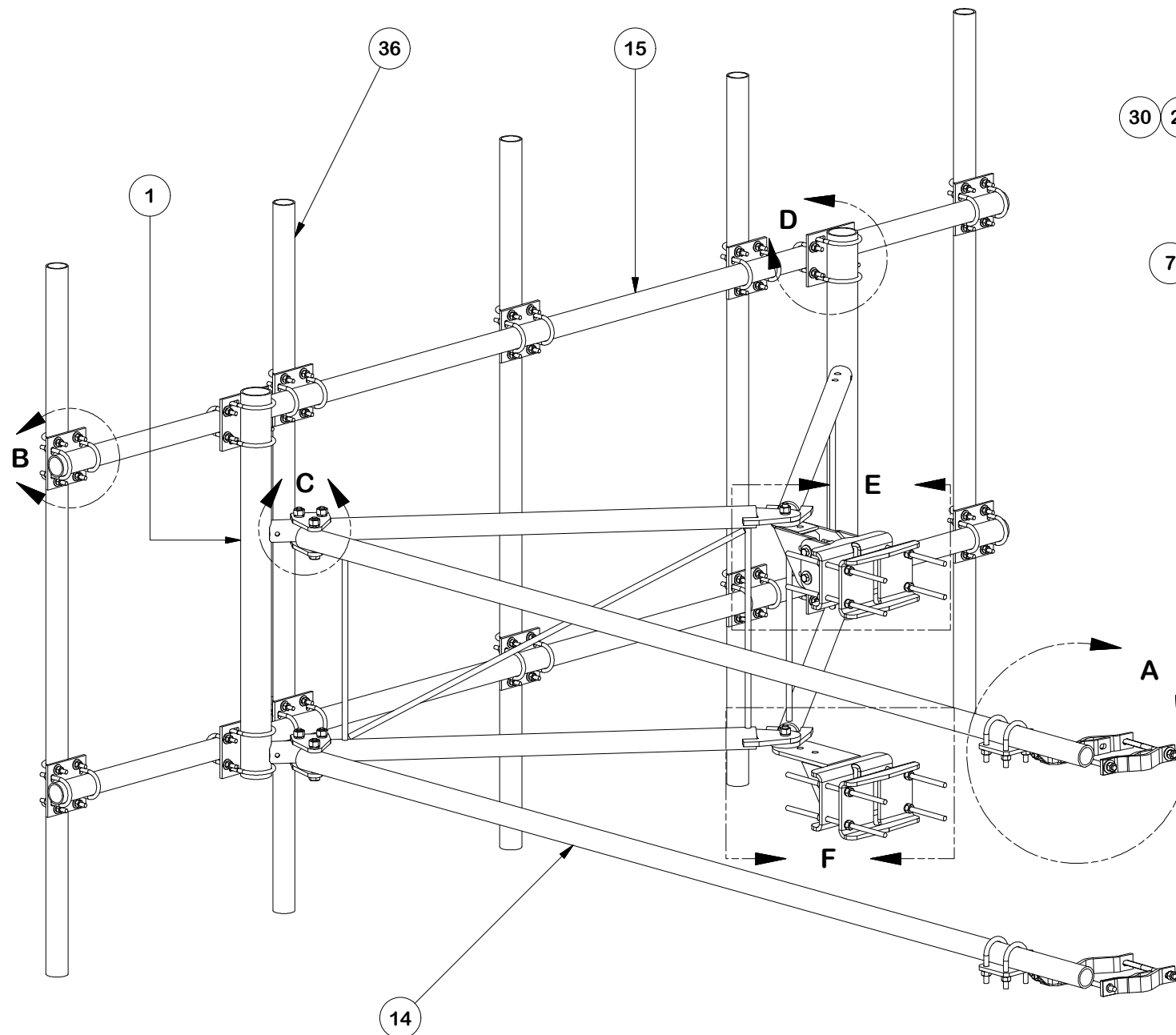

DETAIL A

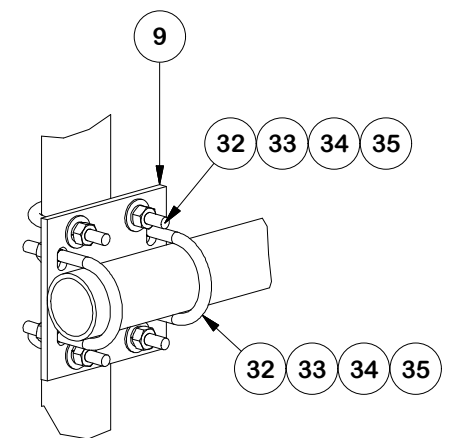

DETAIL B

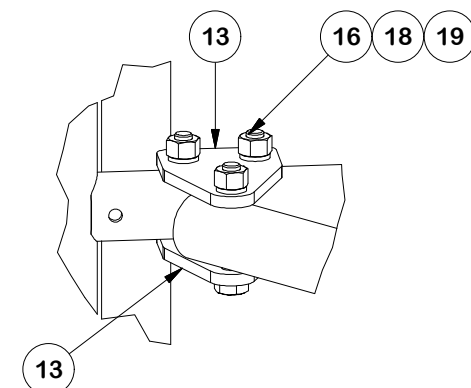

DETAIL C

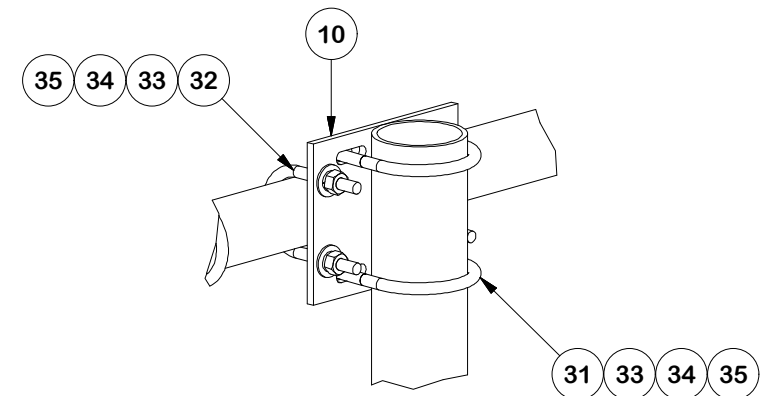

DETAIL D

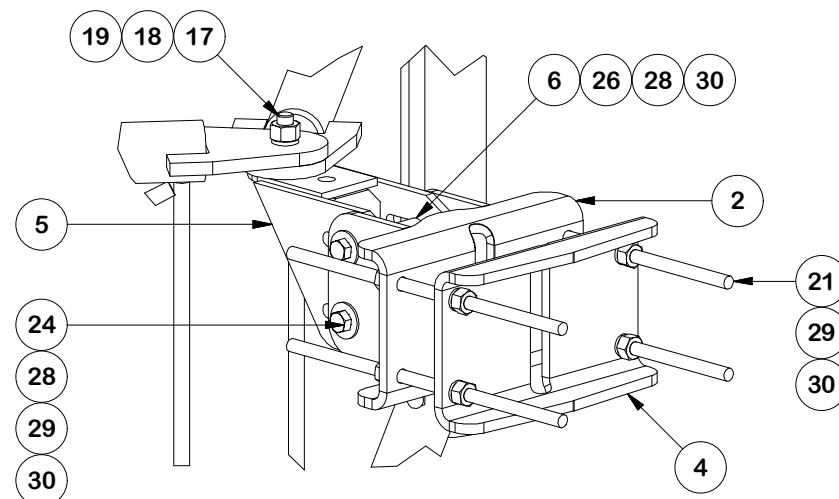

DETAIL E

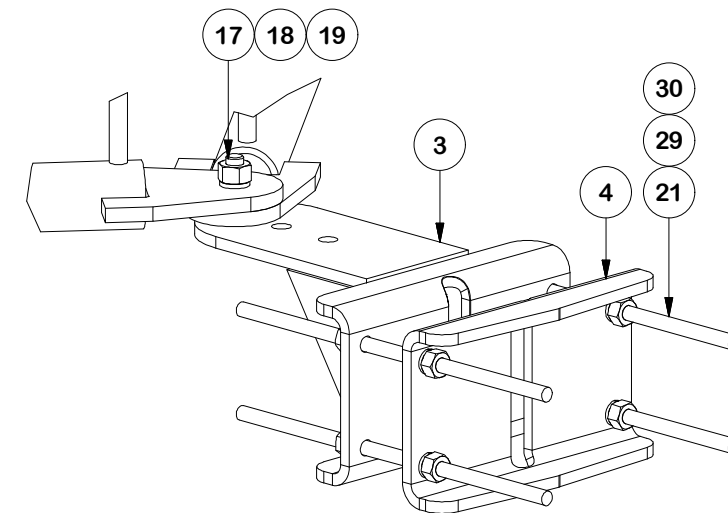

DETAIL F

TOLERANCE NOTES

TOLERANCES ON DIMENSIONS, UNLESS OTHERWISE NOTED ARE:
SAWED, SHEARED AND GAS CUT EDGES ($\pm 0.030''$)
DRILLED AND GAS CUT HOLES ($\pm 0.030''$) - NO CONING OF HOLES
LASER CUT EDGES AND HOLES ($\pm 0.010''$) - NO CONING OF HOLES
BENDS ARE $\pm 1/2$ DEGREE
ALL OTHER MACHINING ($\pm 0.030''$)
ALL OTHER ASSEMBLY ($\pm 0.060''$)

PROPRIETARY NOTE:
THE DATA AND TECHNIQUES CONTAINED IN THIS DRAWING ARE PROPRIETARY INFORMATION OF VALMONT INDUSTRIES AND CONSIDERED A TRADE SECRET. ANY USE OR DISCLOSURE WITHOUT THE CONSENT OF VALMONT INDUSTRIES IS STRICTLY PROHIBITED.

DESCRIPTION
14' 6" HEAVY-DUTY BOG V-FRAME
W/ 2-7/8" ANTENNA PIPES
AND DOUBLE TIEBACKS

CPD NO.		DRAWN BY CMFL 11/2/2021		ENG. APPROVAL	
CLASS 87	SUB 02	DRAWING USAGE CUSTOMER		CHECKED BY BMC 11/2/2021	

SITE
PRO

1

A valmont COMPANY

Locations:
New York, NY
Atlanta, GA
Los Angeles, CA
Plymouth, IN
Salem, OR
Dallas, TX

Engineering
Support Team:
1-888-753-7446

PART NO.	VOG14-WLL-3XX	PAGE 3 OF 3
DWG. NO.	VOG14-WLL-3XX	